



# CORTEX

Multi-level self-loading stretcher

Code: 21-00059



The **Cortex** multi-level stretcher is designed to ensure the **safe transport of the patient** to the rescue vehicle. It allows a correct loading and unloading procedure without the use of levers to **minimise operator effort**.

### MAIN FEATURES

- ▶ **Multi-level.** 5 possible heights facilitate rescue procedures by lightening the load on the back during lifting manoeuvres.
- ▶ **Lightweight and sturdy.** The anodised aluminium alloy structure can carry up to 250 kg.
- ▶ **Rear wheels with integrated brake.** The rear caster wheels with a diameter of 150 mm have a safety brake to prevent accidental movements.
- ▶ **Front caster wheels with directional lock.** The 150-mm diameter front castor wheels can be set as fixed or swivelling, using the appropriate lever, according to the operator's needs, to allow lateral approach to the patient's bed and better management of the equipment in tight spaces.
- ▶ **Easy to load and unload.** The Easy Load system allows loading the stretcher without the need to operate any levers, making the manoeuvre safer for the patient and easier for the operator. Unloading is safe and risk-free thanks to the fall protection system.
- ▶ **Adjustable backrest.** The backrest is adjustable up to a maximum inclination of 80°.
- ▶ **Comfortable for the patient.** Depending on the patient's needs, the foot end frame can be set to the antalgic position (Contour position) and the anti-shock position with the practical lever.
- ▶ **Can be used as a field stretcher.** The leg locking system keeps the stretcher legs raised and locked, thus allowing it to be used as a field stretcher in case of obstacles or rough terrain.
- ▶ **Folding side rails.** The stretcher comes standard with a pair of folding side rails, which can be unlocked with the special pin.
- ▶ **It's designed for performing life-saving manoeuvres** thanks to its rigid ABS tops.
- ▶ **It allows for the transport of incubators**, as it is compatible with the dedicated ITC interface (Incubator Transport Interface).
- ▶ **Easy to clean.** The ABS tops can be removed to make cleaning operations even easier.

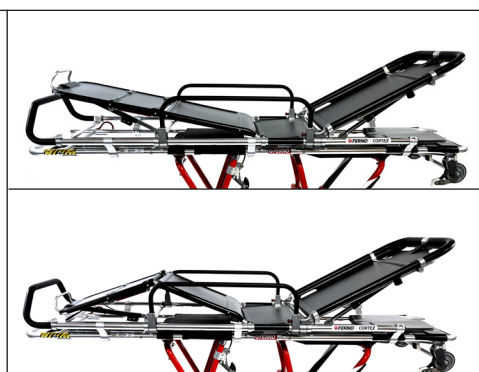
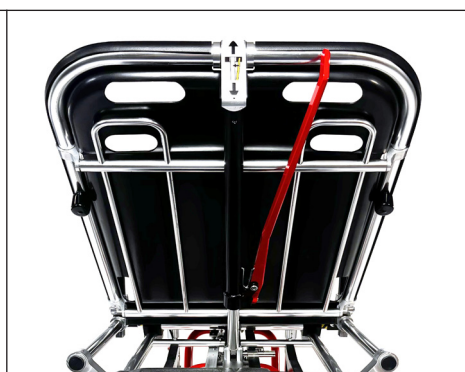
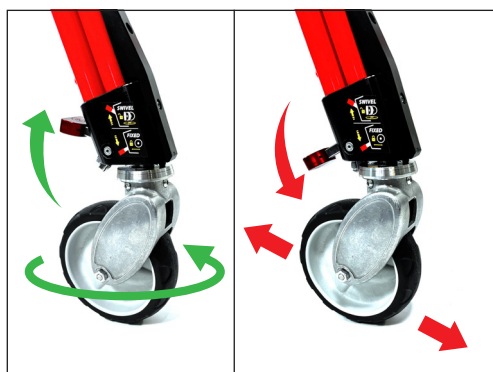

## COMPATIBLE ACCESSORIES



### ► 5-section mattress with cushion

Code: 25-00200

The five-section mattress makes it possible to follow the inclinations of the frame in all possible positions. The mattress includes a cushion with straps, which allow it to be flipped over without losing it when not in use.

### ► Surface Extender

Code: 21-00066

The Cortex Surface Extender is a kit for extending the surface area of the stretcher using ScoopEXL and an inflatable mattress.

The Cortex Surface Extender consists of:

- four clamps with an attachment for TSL, two on the right and two on the left side of the stretcher;
- two side supports for the side edges;
- two-way inflatable mattress with inflatable support cushions (4 three-chamber cushions, 2 single-chamber cushions);
- inflation connector;
- USB rechargeable electric inflation pump.
- Repair kit.

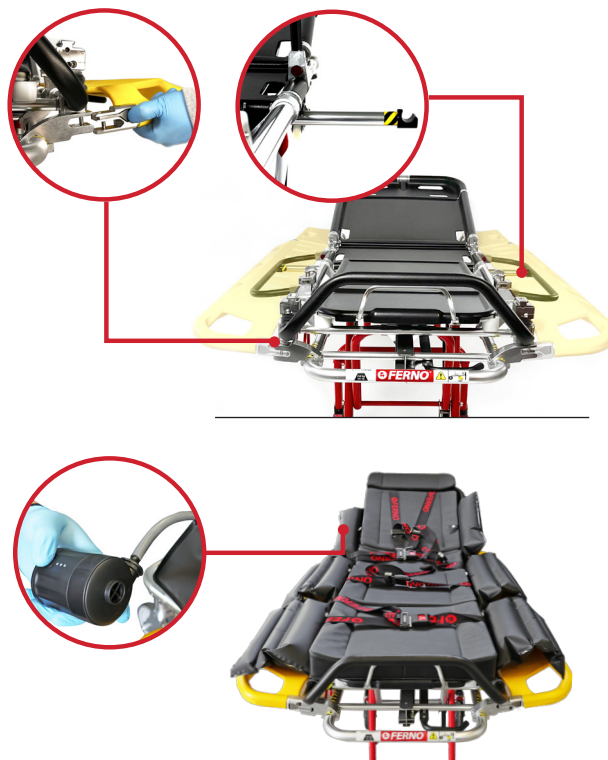

### ► Adapter Kit for PacRac+

Code: 25-00214

The Adapter Kit consists of four clamps with an attachment for PacRac+ that allow quick installation when needed.

## OTHER COMPATIBLE ACCESSORIES

| DESCRIPTION                                    | PART NO.          |
|--|-------------------|
| Four-point restraint                           | 0313915           |
| Two-piece restraint                            | 430-2-N           |
| Safe Transfer Super Comfort mattress           | 271029000         |
| Inflatable mattress                            | 25-00259-M01      |
| Inflation pump                                 | 10-00703          |
| Inflation connector                            | 10-00694          |
| PacRac+  | FWEPR+IT          |
| IV Pole  | 0087156           |
| Yellow ScoopEXL kit                            | KIT-SCOOPEXL      |
| Red ScoopEXL kit                               | 21-00038          |
| Adjustable extensions for stretcher restraints | 0313659-IT        |
| Emergency Kit                                  | 21-00026          |
| Slam locking                                   | SLAM-5026/MONDIAL |
| ITC (incubator fixing interface)               | ITC-HL            |
| Neomate (Paediatric transport system)          | 0314116           |
| Pedimate Plus (Paediatric transport system)    | 0314115           |
| Patient Shield                                 | 0822097           |
| Document holder kit                            | 25-00273          |

## TECHNICAL SPECIFICATIONS

|               |                                     |
|---------------|-------------------------------------|
| Length        | 1970 mm                             |
| Width         | 560 mm                              |
| Height        | (maximum, with backrest up) 1500 mm |
| Weight        | 47 kg                               |
| Load capacity | 250 kg                              |

## CERTIFICATION



The product meets the general safety and performance requirements of **Regulation (EU) 2017/745 (MDR)** concerning medical devices.

Compliant with **EN1865** and compatible with the SLAM locking system for ambulance transport (**EN 1789**-certified system).